

Application Technology of WICI Waterproofing and Insulation Composite Integration System

Shenzhen Joaboa Technology Co., Ltd.

Jack Song



Introduction of WICI System

1. Product Structure

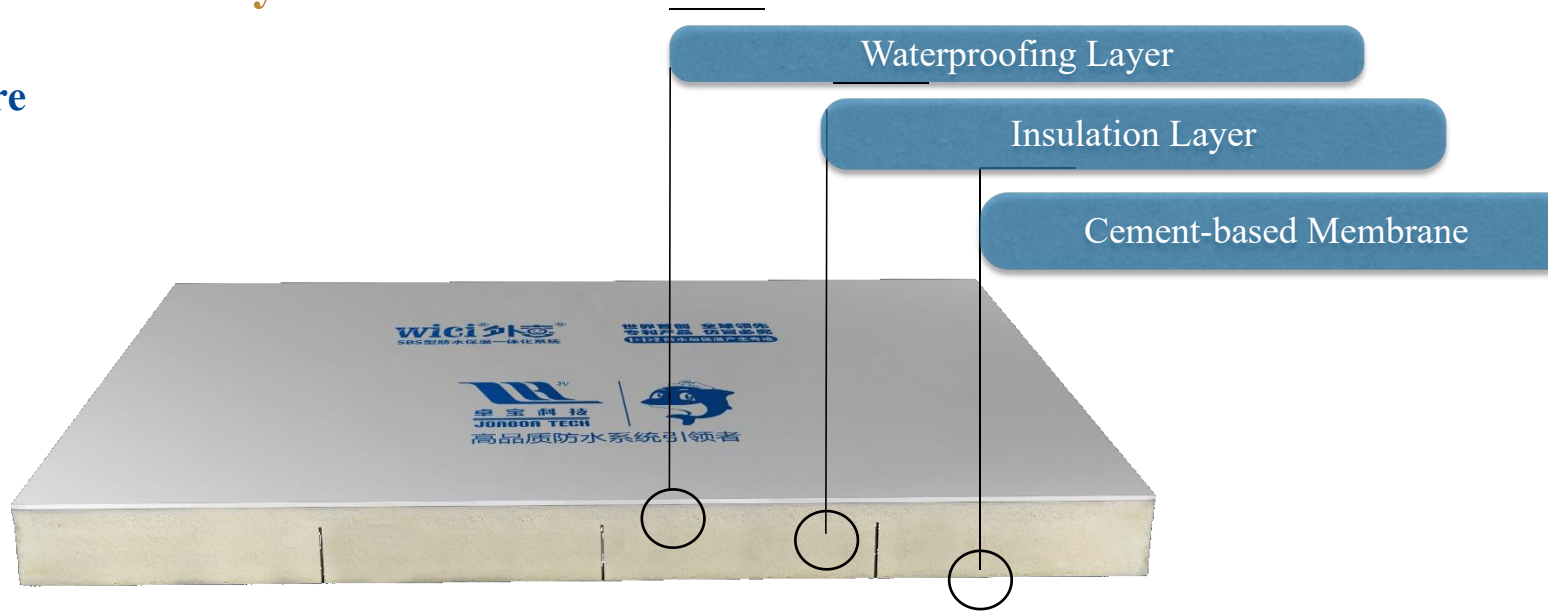

Waterproofing layer: Bitumen membrane/PVC/TPO Waterproofing Sheet

Insulation layer: Rigid foam PU, Rock Wool, XPS, EPS

Size: W: 1200mm; L: 7500mm (thickness range from 30mm to 100mm, based on the energy-saving demand

Introduction of WICI System

2. Using Range



Green Roof



Green Slab

Introduction of WICI System

3. Roof Structure

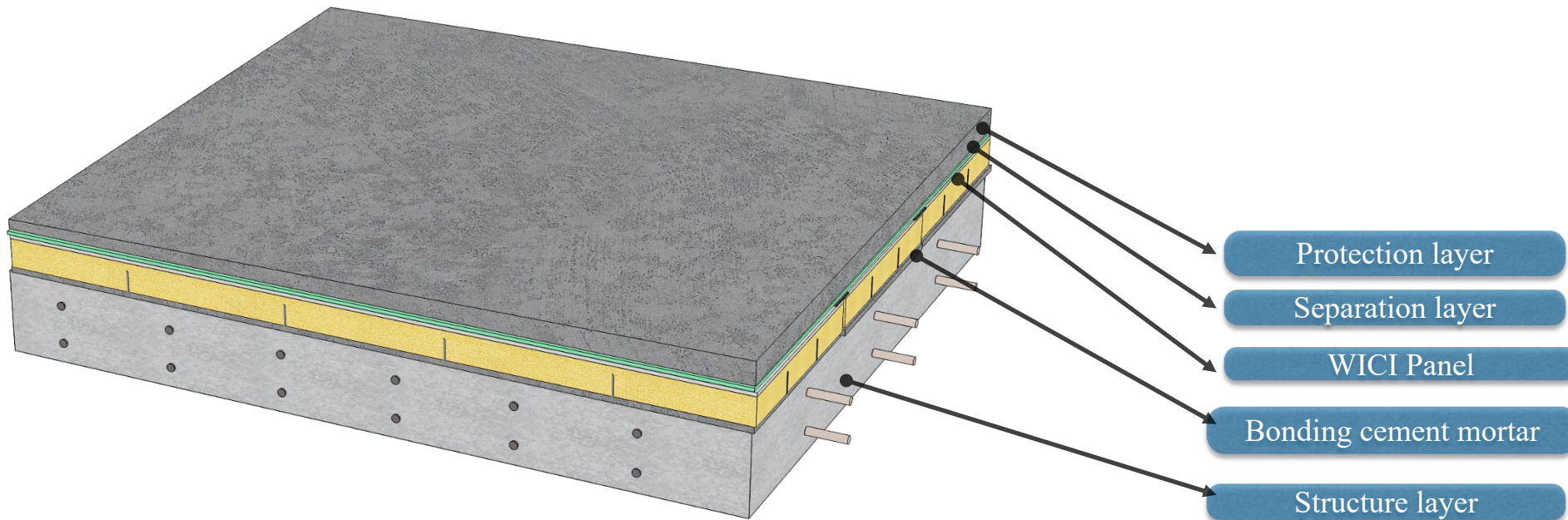

Application Method of WICI System

1. Reinforcement for detailed parts

- Wet apply the double side self adhesive waterproof membrane at the node part such as parapet, gable and post-poured belt to strengthen them.



Application Method of WICI System—PVC Type

2. Substrate treatment



- **Spray a layer of polymer cement waterproof coating on the substrate to waterproof and do the substrate treatment. The main function is as followed.**
 1. repair the cracks on the substrate
 2. Strengthen the bonding effect between bonding cement mortar and the concrete substrate
 3. Prevent the water in bonding cement mortar losing too fast

Application Method of WICI System—PVC Type

3. Pre-pave the panel



Application Method of WICI System—PVC Type

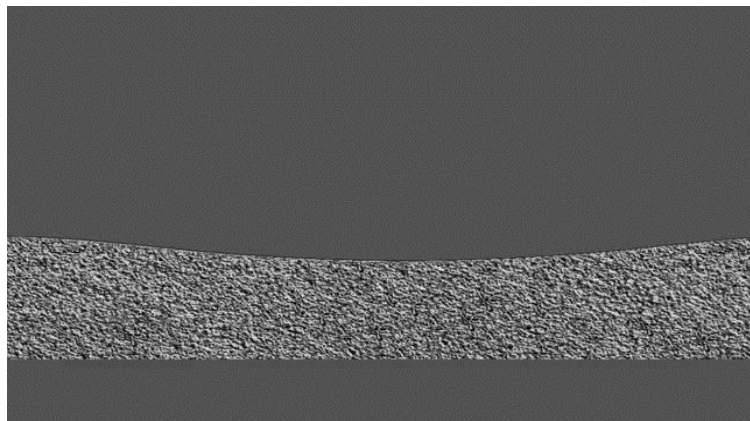
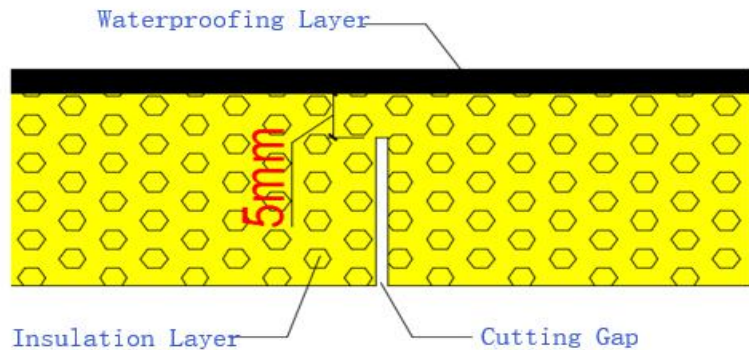

30cm * 30cm

Cutting Gap

Application Method of WICI System—PVC Type

4. Fold back the panel ---Release Stress



Application Method of WICI System—PVC Type

5. Prepare Waterproof bonding cement mortar

◆ 0.28 Ratio between Water and Cement Mortar

